

WAFER TYPE BUTTERFLY VALVE

SPECIFICATION

FOR BS 4504 PN25 FLANGE MOUNTING
FACE-TO-FACE DIMENSION TO ISO 5752 / BS 5155 / BS EN 593
LEVER / WORM GEAR OPERATOR

PRESSURE / TEMPERATURE RATINGS

Working Pressure	25 bar
Testing Pressure	Shell : 37.5 bar Seat : 27.5 bar
Working Temperature	-20°C to 110°C (EPDM Seat) -10°C to 80°C (NBR Seat)
Suitable Media	Water, Oil & Gas

MATERIALS

Part	Material	BS
Body	Ductile Iron	2789 Gr. 420/12
Disc	Ductile Iron	2789 Gr. 420/12
	Aluminum Bronze	1400 AB2
	Stainless Steel 304	304 C15
	Stainless Steel 316	316 C16
Seat Ring	EPDM	
	NBR	
	PTFE	
	Viton	
Shaft	Stainless Steel 410	410 S21
	Stainless Steel 431	431 S29
	Stainless Steel 316	316 S16
Taper Pins	Stainless Steel 316	316 S16
Key	Carbon Steel	
O-Ring	NBR	
Bushing	PTFE	

DIMENSIONS

Size mm	A mm	B mm	C mm	D mm	E mm	F mm	G mm	Cv 90°
50	42	80	195	267	272	173	150	135
65	45	89	208	267	287	173	150	220
80	45	97	213	267	292	173	150	302
100	52	114	234	267	310	173	150	600
125	54	127	246	267	325	173	150	1022
150	56	140	259	267	338	173	150	1579
200	61	175	-	-	452	239	285	3136
250	66	203	-	-	485	239	285	5340
300	77	244	-	-	526	226	285	8250

Note:

1. Actuator mounting flange conforms to ISO 5211 drilling.
2. The butterfly valve can be supplied with electric or pneumatic actuator.
3. Pneumatic actuators are available in spring return or double acting.
4. Micro switch / limit switch box are available upon request.
5. Other flange standards available upon request.
6. If used for gas application, please consult our sales office.
7. Design and specifications are subject to change without prior notice

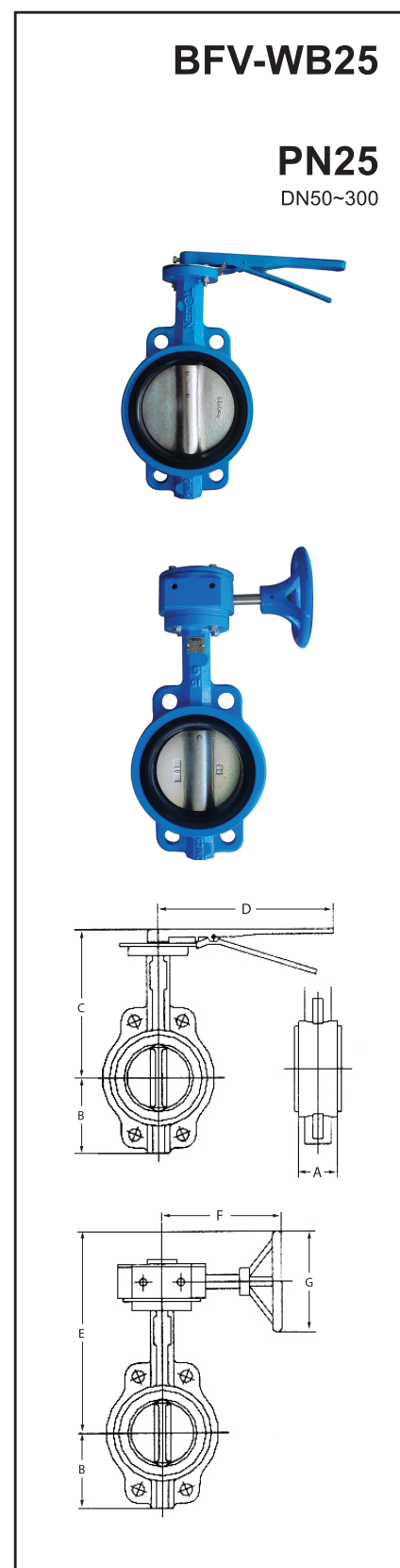

WAFER TYPE BUTTERFLY VALVE

SPECIFICATION

FOR JIS B2239 10K / 16K FLANGE MOUNTING
FACE-TO-FACE DIMENSION TO ISO 5752 / BS 5155 / BS EN 593
LEVER / WORM GEAR OPERATOR

PRESSURE / TEMPERATURE RATINGS

Working Pressure	1.6 Mpa
Testing Pressure	Shell : 2.4 Mpa Seat : 1.76 Mpa
Working Temperature	-20°C to 110°C (EPDM Seat) -10°C to 80°C (NBR Seat)
Suitable Media	Water & Oil

MATERIALS

Part	Material	JIS
Body	Cast Iron	FC 25
	Ductile Iron	FCD 40
Disc	Ductile Iron	FCD 40
	Aluminum Bronze	ALBC 2
	Stainless Steel 304	SCS 13
	Stainless Steel 316	SCS 14
Seat Ring	EPDM	
	NBR	
	PTFE	
	Viton	
Shaft	Stainless Steel 410	SUS 410
	Stainless Steel 431	SUS 431
	Stainless Steel 316	SUS 316
Taper Pins	Stainless Steel 316	SUS 316
Key	Carbon Steel	
O-Ring	NBR	
Bushing	PTFE	
	(DN50~600) Luberized Bronze	(DN50~1000)

DIMENSIONS

Size mm	A mm	B mm	C mm	D mm	E mm	G mm	Cv 90°
40	33	68	134	267	217	150	80
50	42	80	193	267	274	150	135
65	45	89	207	267	288	150	220
80	45	95	213	267	294	150	302
100	51	114	232	267	313	150	600
125	55	127	245	267	326	150	1022
150	55	144	258	267	339	150	1579
200	60	175	295	358	448	300	3136
250	67	203	327	358	480	300	5340
300	76	242	372	358	526	300	8250
350	76	272	-	-	556	300	11917
400	102	333	-	-	648	385	16388
450	114	364	-	-	670	385	21705
500	130	389	-	-	744	385	27908
550	151	431	-	-	797	385	34815
600	151	453	-	-	826	385	43116

BFV-WJ

16K

DN50~600

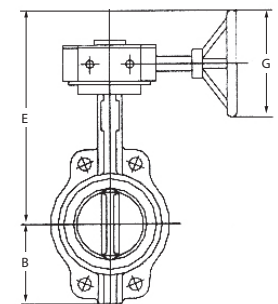
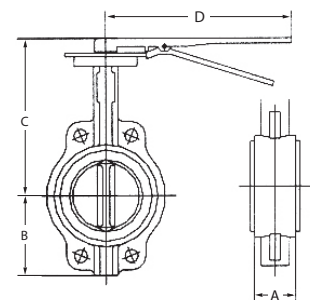

WAFER TYPE BUTTERFLY VALVE

SPECIFICATION

DOUBLE-STAGE WORM GEAR OPERATOR

PRESSURE / TEMPERATURE RATINGS

Working Pressure	1.0 Mpa
Testing Pressure	Shell : 1.5 Mpa Seat : 1.1 Mpa
Working Temperature	-20°C to 110°C (EPDM Seat) -10°C to 80°C (NBR Seat)
Suitable Media	Water & Oil

DIMENSIONS

Size mm	A mm	B mm	Double-Stage Worm Gear Operator		Cv 90°
			C mm	G mm	
700	165	527	1002	425	49500
800	190	591	1039	425	68250
900	205	650	1131	425	86375
1000	218	715	1209	425	119750

Note:

1. Actuator mounting flange conforms to ISO 5211 drilling.
2. The butterfly valve can be supplied with electric or pneumatic actuator.
3. Pneumatic actuators are available in spring return or double acting.
4. Micro switch / limit switch box are available upon request.
5. Other flange standards available upon request.
6. If used for gas application, please consult our sales office.
7. Design and specifications are subject to change without prior notice.

BFV-WJ

10K

DN700~1000

