

Tube Fitting Brass Series

FITTING

KL Elbow

RoHS compliant

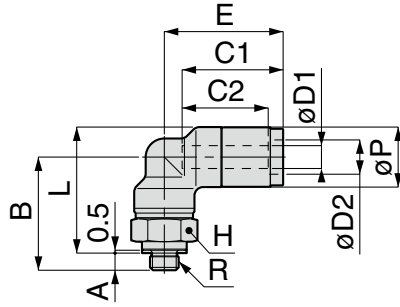

Metric thread

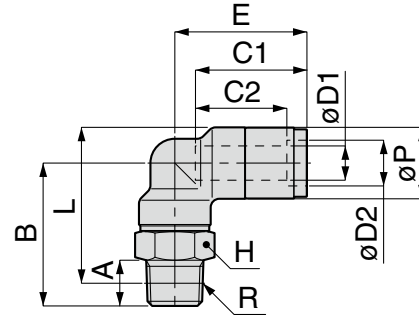

Taper pipe thread

Unit : mm

Model code	Tube O.D. øD1	Tube O.D. øD2	R	A	B	L	øP	Tube end C1	Tube end C2	E	Hex. H	Orifice dia.	Weight (g)	Effective area (mm ²)
KL4-M5-□	4	6	M5×0.8	3	19.8	22	10.5	17.6	15	20.7	10	1.8	18	1.5
KL4-01-□			R1/8	8	22.8	24.1						2.5	21	
KL4-02-□			R1/4	11	25.8	25						14	31	
KL6-M5-□	6	8	M5×0.8	3	22	25.3	12.5	19.4	16	23	12	1.8	26	1.9
KL6-01-□			R1/8	8	25	27.3						28		
KL6-02-□			R1/4	11	28	28.2						4	36	
KL6-03-□			R3/8	12	29.8	29.7					17	49	9	
KL8-01-□	8	10	R1/8	8	28	31.3	14.5	20.2	17	24.8	14	6	36	16
KL8-02-□			R1/4	11	31	32.2							41	
KL8-03-□			R3/8	12	32.8	33.7							17	
KL10-01-□	10	12	R1/8	8	32.5	37.8	18.6	23.2	19.5	29.3	17	6	67	22.5
KL10-02-□			R1/4	11	35.5	38.8						69		
KL10-03-□			R3/8	12	38.5	39.5						8	78	
KL10-04-□			R1/2	15	39.5	40.6					22	104	30	
KL12-02-□	12	14	R1/4	11	37.5	42.3	21.6	26.3	23	33.4	21	8	107	38
KL12-03-□			R3/8	12	38.5	43						9	113	
KL12-04-□			R1/2	15	41.5	44.1						22	129	

※ 1. "L" is a reference value for height dimension after tightening taper thread.

※ 2. □ in Model code / Replaced with "N"(NBR), or "F"(FKM) for Seal rubber material change